

Cleaning and Sterilization

For detailed sterilization instructions, please refer to industry standards ANSI/AAMI ST79:2012 & A1:2012 and ANSI/AAMI ST8:2001.

NOTE: All Shukla Medical surgical instruments require manual cleaning with a neutral pH cleanser. Open and disassemble all instruments, making sure to remove all contamination during cleaning. Instruments must be reassembled prior to sterilization. Machine washing is not recommended. Maintenance and care using an autoclaveable lubricant on movable parts is required to preserve the life of the instrument. For more cleaning, inspection, maintenance, and care tips, contact Shukla Medical directly.

The instrument case must be sterilized following the parameters listed below:

Sterilizer Type: Prevacuum
Preconditioning Pulses: 4
Temperature: 132° C
Full Cycle Time: 4 minutes

Dry Time: 60 minutes
Open Door Time: 15 minutes
Cool-down Time: 30 Minutes outside of chamber on a wire rack

Disassembly Instructions: 104-04 Hip Stem Extractor

Xtract-All® Universal Hip Stem Extractor Assembly (104-04) must be disassembled completely for cleaning. All contamination must be removed at this stage. The extractor must be reassembled prior to sterilization.

1. Unscrew the cam cap by lifting the cam handle & turning counterclockwise
2. Remove the push rod from inside the assembly
3. Grasp the curved jaw and slide out from the curved body
4. Unthread the cam cap screw from the pin using 3mm hex key (not included)
5. Pull the cam handle free from the instrument

Disassembled extractor should result in a total of seven (7) pieces:

- A. Curved body (104-04-01)
- B. Curved jaw (104-04-02)
- C. Push rod (104-04-15)
- D. Cam handle (104-04-17)
- E. Screw (104-04-12)
- F. Thread pin (104-04-10)
- G. Cam Cap (104-04-07)

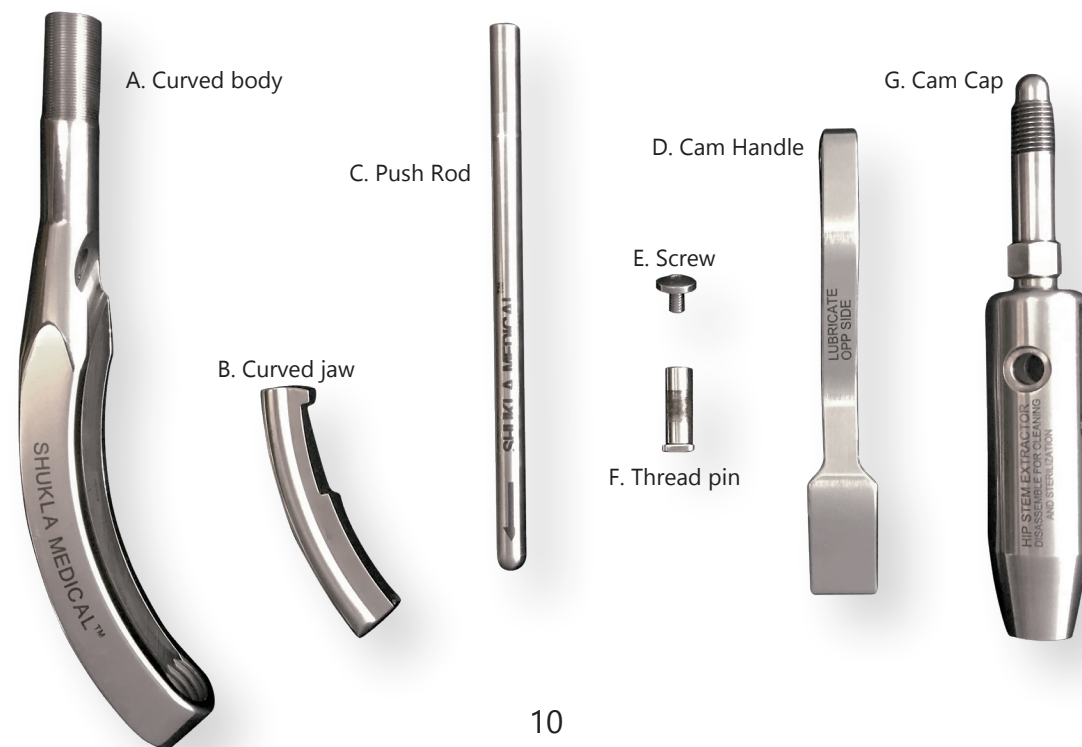

10

Reassembly Instructions: 104-04 Hip Stem Extractor

Once all contamination has been removed from the disassembled extractor, the instrument must be reassembled for sterilization.



1. Insert cam handle into cam cap, lining up holes.



2. Insert threaded pin into holes.



3. Insert screw into threaded pin; tighten using 3mm hex key (not included).



4. Insert curved jaw into curved body. There is an arrow on the jaw to indicate direction.



5. Insert push rod into the curved body, resting on top of the curved jaw. Use the arrow on the jaw as a directional guide.



6. Connect the cam cap/handle assembly to the curved body/jaw assembly via the push rod.

Disassembly Instructions: 120-03 Modular Hip Stem Extractor

The Modular Hip Stem Extractor must be disassembled for cleaning.

1. Use T-handle to loosen extractor jaw and remove Clamping Screw.
2. Unscrew the knurled pivoting screw (Fig. A-1) and remove pivoting body and lever (Fig. A-2).
3. Unscrew Clamping Pin from Extractor tip.
4. Clean extractor as normal.
5. Reassemble prior to sterilization.

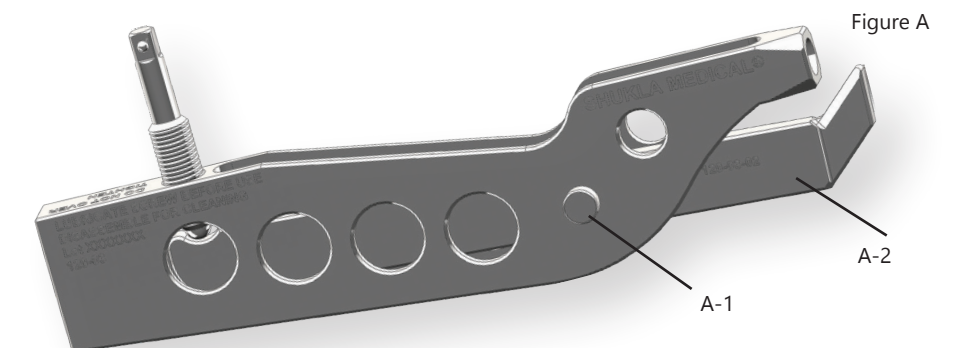

11